



Data-Sheet-Fixed Capacitor

CKT125/21/135



www.glvac.cn

| Specification | |
|--|-----------|
| Capacity C_{max} (nominal) | 125pF |
| Voltage (Peak Test U_{pt} /Peak Working U_{pw}) | 30kV/18kV |
| Capacity tolerance | 5% |
| Max. Current I_{max} at 13.56MHz with | 135Arms |
| Conduction Cooling | 50W |
| Net Weight | 0.52kg |

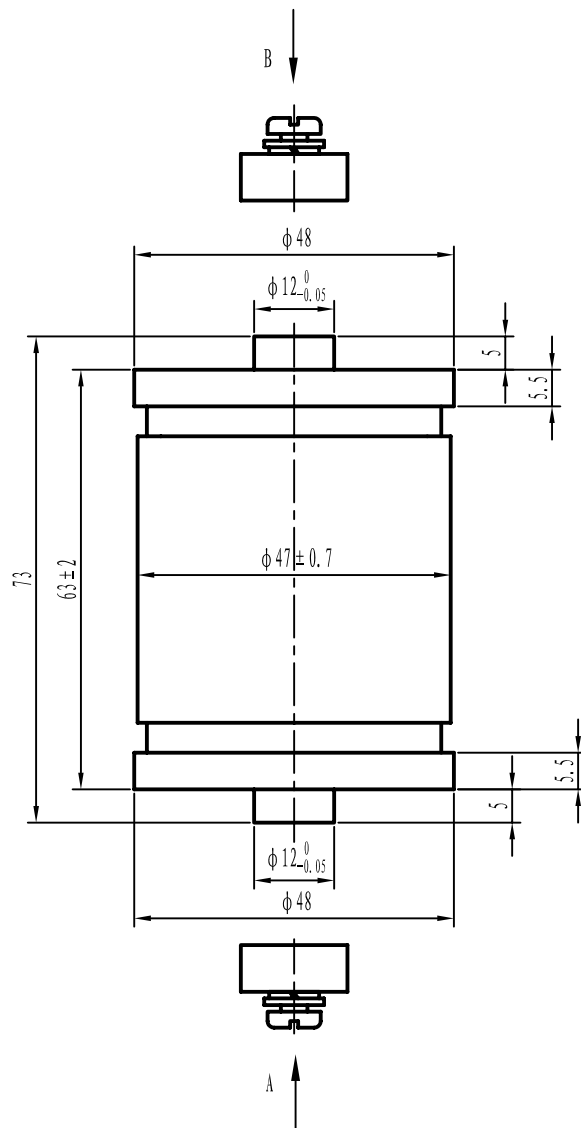

I_{max} at 25 °C ambient and 125 °C surface for convection and conduction (50w) cooling

