



Data-Sheet-Variable Vacuum Capacitor CKTB1000/3.5/89 (III)



www.glvac.cn

Specification	
Capacity C_{max} (nominal)	1000pF
Capacity C_{min} (nominal)	100pF
Voltage (Peak Test U_{pt} /Peak Working U_{pw})	5kV/3kV
Capacity tolerance (liner Range)	10%
Max. Current I_{max} at 5MHz with	89Arms
Convection Cooling	20W
Capacitance per turn	81.1pF/turn
Torque	$\leq 0.2Nm$
Net Weight	0.6kg

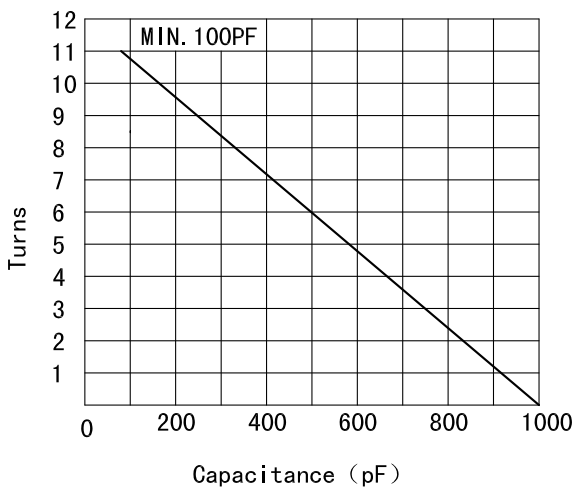
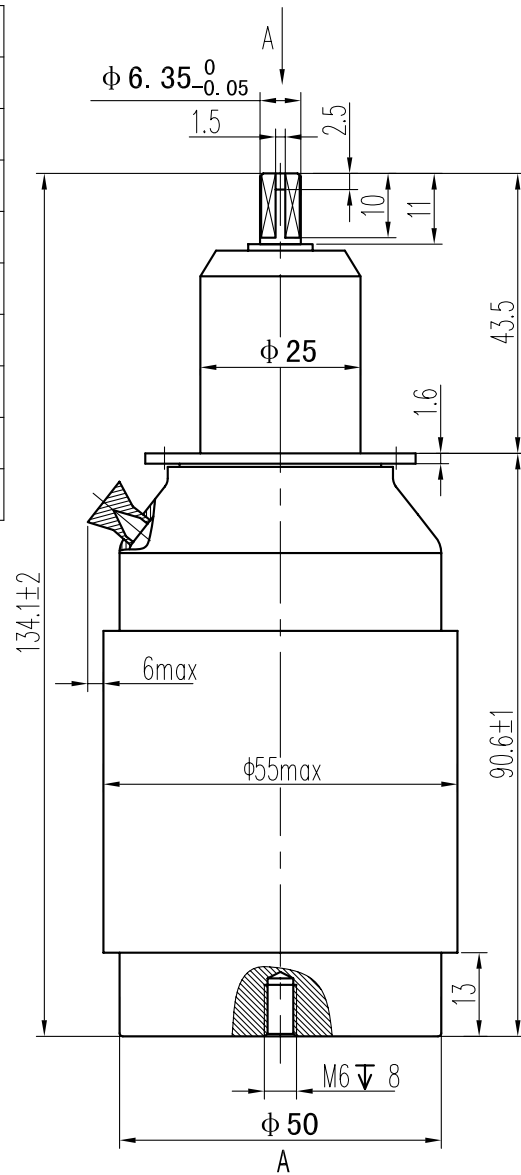

I_{max} at ambient and 125 °C surface temp. for convection and conduction (20w) cooling

